



FIRST Bicycle Components Co.,Ltd.

Classic . Graceful . Perfect Crankset

High performance

RT

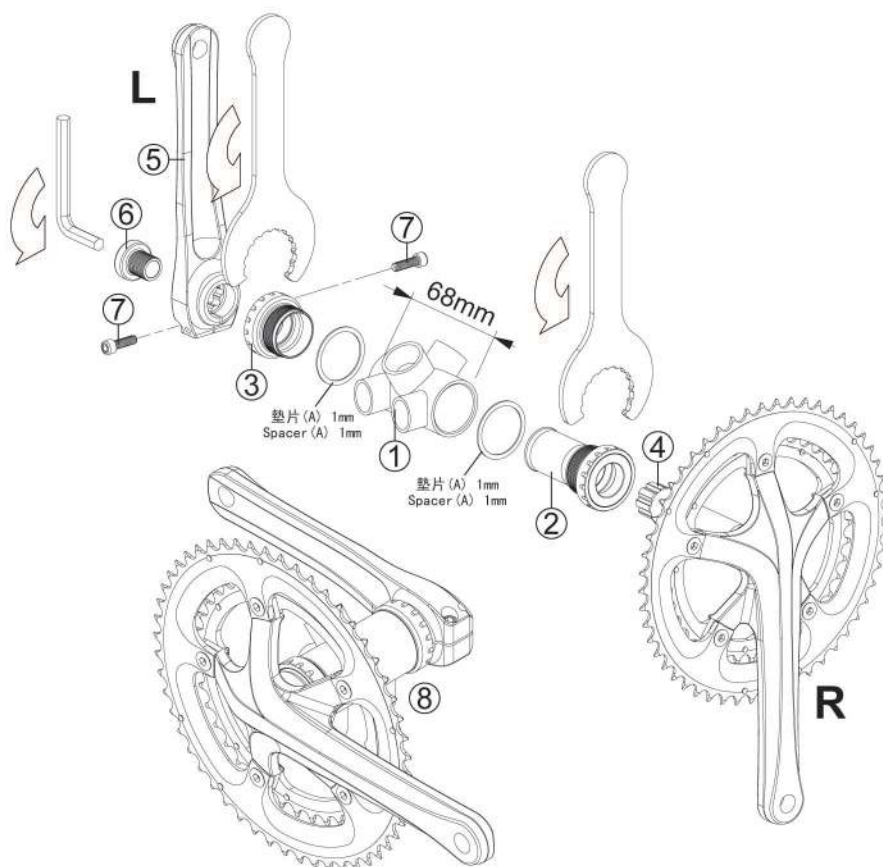

Technical instructions

1. Apply grease to the threads inside the BB shell of the frame.
2. Install the drive-side (R) adapter (counterclockwise thread) and use special external BB cup spline tool to tighten with suggested torque 350-450kgf-cm.
3. Install the non-drive side (L) adapter (clockwise thread) and use special external BB cup spline tool to tighten with suggested torque 350-450kgf-cm.
4. Insert the five-arm right crank set smooth going into the bottom bracket set.
5. Install the corresponding hole of left crank to the spline end of right crank set.
6. Screw the fixing bolt into the hole of spindle of right crank set with a 10mm allen key and make sure the crank set is close and even to the bottom bracket set. Suggested tighten torque 7-15 kgf-cm.
(If the crank set is not close and even to the bottom bracket set, add a spacer or more.)
7. Use 5mm allen key to tighten separately 2 bolts evenly and equally. Suggested tighten torque 120-150 kgf-cm
8. Assembly completed.

Notes : 1.For BB shell width of 68mm, the two 1mm spacers(A) are necessary for assembly.
2.Contrarily, the 1mm spacers(A) are not necessary for BB shell width of 70mm.

MADE IN TAIWAN